

LH400ICA

4" IC Type IC Incandescent New construction Dedicated for Max. 15W LED Lamp

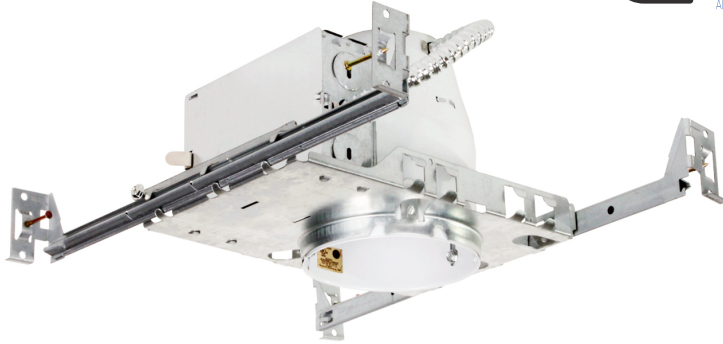

Dimensions

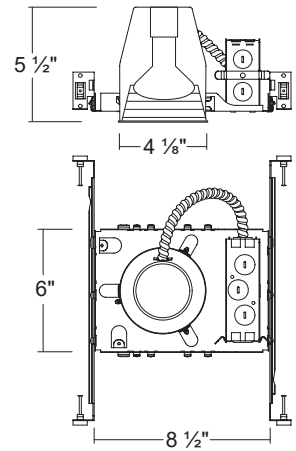

SPECIFICATION

Plaster Frame

- Galvanized steel construction. The housing can be removed from plaster frame to provide access to the junction box

Junction Box

- Listed for through branch circuit wiring
- Contains seven 7/8" knockouts and four Romex pryouts with strain relief

Bar Hanger

- Pre-installed Real nail easily installs in regular lumber, engineered lumber
- Bar Hangers are adjustable from 13-5/8" to 25" and can be repositioned 90 degree on plaster frame

Thermal Protector

- Self resetting thermal protector deactivates fixture if overheating occurs due to improper lamping or misapplied insulation.

Lamp

- Max. 15W Par20 or R20 LED Lamp

Listings

- cULus Listed (1598 Luminaire)
- Damp Location / Wet Location for covered ceiling with select trims
- cULus Listed for Feed Through
- Certified under ASTM-E283 for Air tight construction

ORDERING INFORMATION

Model No.	Description	Max. Wattage
LH400ICA	4" Line Voltage Type IC New construction Housing	15 W

COMPATIBLE TRIMS

T400 Smooth



- Dry / Damp Location
 - Incandescent
- 15W Par/R20 LED Lamp

T403 Stepped Baffle



- Dry / Damp Location
 - Incandescent
- 15W Par/R20 LED Lamp

T404 Wall Wash



- Dry / Damp Location
 - Incandescent
- 15W Par/R20 LED Lamp

T405 Eyeball



- Dry / Damp Location
 - Incandescent
- 15W Par/R20 LED Lamp

T411 Surface Gimbal



- Dry / Damp Location
 - Incandescent
- 15W Par/R20 LED Lamp

T413 AT Cone Stepped Baffle



- Dry / Damp Location
 - Incandescent
- 15W Par/R20 LED Lamp

T408 Albalite Shower



- Dry / Damp Location
 - Incandescent
- 15W Par/R20 LED Lamp

T418 Frosted Shower



- Dry / Damp Location
 - Incandescent
- 15W Par/R20 LED Lamp

